

# UNE'S PRODUCT RANGE / UNEFLEX

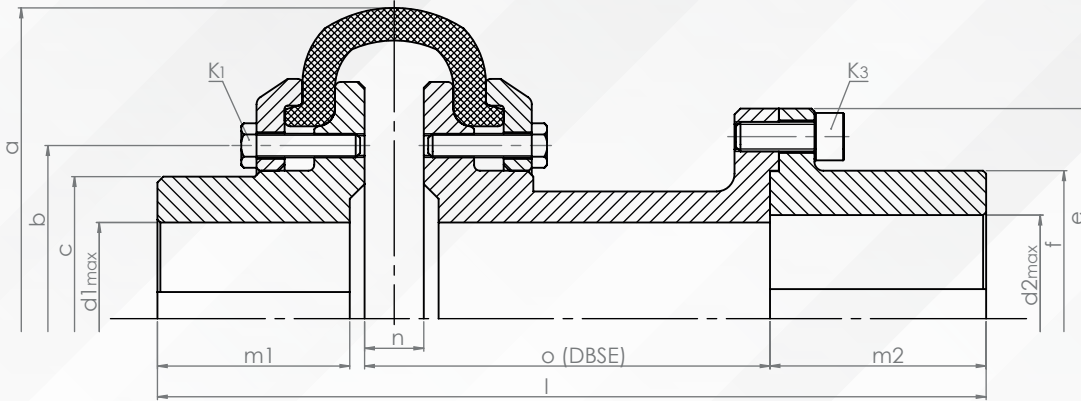

## Uneflex SD Series | Coupling with dismantling spacer for pump drives

Coupling Size	2S-100	2S-140	6S-100	6S-140	16S-100	16S-140	40S-140	40S-180	63S-140	63S-180	125S-180	125S-250	125S-350
Nominal Torque [Nm]	50	50	100	100	200	200	400	400	800	800	1.600	1.600	1.600
Max. Speed [rpm]	5.000	5.000	5.000	5.000	4.000	4.000	4.000	4.000	3.000	3.000	3.000	3.000	3.000
<b>Diameter [mm]</b>													
a	104	104	136	136	178	178	210	210	263	263	310	310	310
b	54	54	68	68	88	88	116	116	140	140	180	180	180
c	40	40	55	55	70	70	92	92	107	107	140	140	140
d1max	28	28	38	38	48	48	65	65	75	75	100	100	100
d2max	32	32	45	45	55	55	70	70	80	80	100	100	110
e	79	79	97	97	120	120	142	142	160	160	218	218	245
f	48	48	65	65	80	80	100	100	112	112	140	140	168
Screws K1	6xM6	6xM6	6xM6	6xM6	8xM8	8xM8	12xM8	12xM8	8xM12	8xM12	8xM16	8xM16	8xM16
Screws K3	8xM6	8xM6	8xM8	8xM8	8xM10	8xM10	8xM10	8xM10	8xM12	8xM12	10xM16	10xM16	10xM20
<b>Length [mm]</b>													
l	181	221	211	251	221,5	261,5	285	325	308	348	395	465	585
m1	30	30	45	45	50	50	65	65	75	75	100	100	100
m2	50	50	60	60	66	66	75	75	85	85	105	105	105
n	8	8	8	8	19	19	20	20	24	24	20	20	20
o (1)	100	140	100	140	100	140	140	180	140	180	180	250	350
<b>Mass Moment of Inertia &amp; Tyre No.</b>													
Inertia J [kgm <sup>2</sup> ] (2)	0,002	0,002	0,006	0,006	0,018	0,018	0,049	0,049	0,137	0,038	0,391	0,392	0,498
Mass [kg] (2)	2,46	2,60	4,91	5,05	8,78	9,14	16,4	16,8	27,4	27,9	53,1	54,5	72,0
Tyre Ref.	203	203	206	206	210	210	214	214	218	218	222	222	222

(1) Other distance dimensions o (DBSE) available on request

(2) The value of the complete coupling

\* Also available for taper bush

\* Couplings with dismantling spacer are also supplied with M and F series tyres. Ask for more information if required.

# UNE'S PRODUCT RANGE / UNEFLEX

## Safety Mortises

All Uneflex couplings are available with safety mortises. In case of a tyre rupture, the safety mortises act as a torsionally rigid transmission element, permitting a temporary emergency operation with limited torque free of backlash. For the installation of Uneflex couplings with safety mortises, an angle of 45° must exist between the mortises of the coupling hubs.

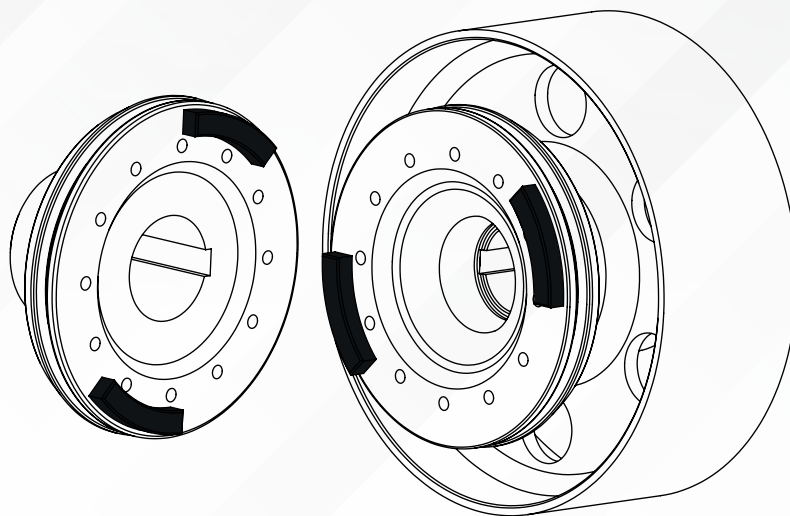

## Tightening Torque of the Screws

### M and T Series

Coupling Size	M-2	M-3	M-4	M-5	M-6	M-7	M-8	M-9	M-10	M-11	M-12	M-13
$K_1 T_A$ [Nm]	4	6	15	20	25	30	45	55	60	110	200	240

### -1, DVA, DVS, SD, P and D Series

Coupling Size	01-1 DVA-1	03-1 DVA-2	06-1 DVA-6	10-1 DVA-16	14-1 DVA-40	18-1 DVA-63	22-1 DVA-125	25-1 DVA-200	26-1 DVA-300	28-1 DVA-400	30-1 DVA-800	32-1 DVA-1500
$K_1 T_A$ [Nm]	1,5	4	6	15	20	25	45	55	60	110	200	240

### SD Series

$K_3$ Thread Dimension	M6	M8	M10	M12	M16	M20
$K_3 T_A$ [Nm]	10	25	49	86	210	410

### D Series

Disc Ø	315	355	400	450	500	550	630	710	800
$K_4 T_A$ [Nm]	49	86	135	210	290	290	410	550	710



Cr. GI-2632 km7,8  
20709 Ezkio (Guipúzcoa), Spain  
+34 943 72 07 65  
[comercial@grupooria.com](mailto:comercial@grupooria.com)  
[www.eganagroup.com](http://www.eganagroup.com)